

Analog Timers

Models
DLT-1
DPT-1
RT-1

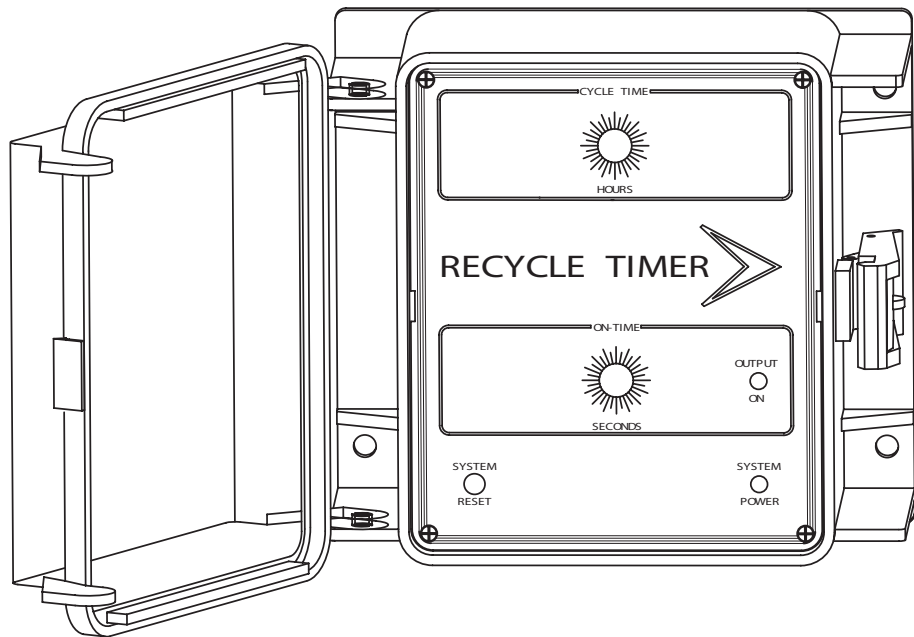

Key Features

- NEMA 4X Type Enclosure
- Simple to Operate
- Precise Electronic Timing
- LED Indicator Lights
- Prewired Configuration
- Front Panel Settings
- Timer Reset Switch
- 2 Year Replacement Warranty

Application

Advantage Controls' analog series timers provide digitally accurate timers to control feed pumps or other equipment.

DLT feed limit timers start when power is applied and stop when the user set length of limit time has elapsed. Once power is removed the DLT timer automatically resets.

DPT percentage timer's relay on timer is adjustable from 0 to 100% of a fixed cycle time. This cycle time is repeated while power is supplied to the unit.

RT recycle timers provide a continuously repeated on and off time with both the cycle time length and the on time length user adjustable.

Options

Your unit may be supplied with one or more options. Option codes will be shown at the end of model number. Example: DPT-1D-2.

- C** 230 Volt
- D** Other time Scale - (DLT & DPT only)
- D-1 0-31 Seconds
 - D-2 0-155 Seconds
 - D-3 0-31 Minutes
 - D-4 0-62 Minutes
 - D-5 0-62 Seconds
 - D-6 0-155 Minutes
 - D-7 0-10 Minutes, 20 Seconds
 - D-8 0-7 hours, 45 minutes
 - D-9 0-310 seconds
- E** Extra Female cord
- L** Optional Scales (RT-2 only)
A cycle time and an ON time must both be selected. Example RT-1L1B
- | Cycle Time | On Time |
|--------------------|------------------------|
| 1 0-31 hr | A 0-31 seconds |
| 2 0-15.5 hr | B 0-155 seconds |
| 3 0-7.75 hr | C 0-31 min |
| | D 0-7.75 min |
- 5** Mounted Flow Switch
- W-1** Single 25 amp output relay.

Notes: 1. Other scales are available, consult factory.

2. All timer scales are adjustable in increments equal to the maximum scale time divided by 31.

Specifications

Electrical:

- **Input:** 115 VAC, 50/60 Hz.
- **Control Output:** 115 VAC, 12 Amp resistive

Prewired with 8 foot power cord with molded plug. Female output cord with molded plug for each output.

Timer Settings (Standard)

- **DLT-1:** 0-90 minutes
- **DPT-1:** 0-10.5 minutes
- **RT-1** Cycle Time: 0-7.75 hours
ON Time: 0-31 minutes

Enclosure

Heavy duty, NEMA 4X type, high impact thermoplastic with padlockable gasketed Lexan viewing door.

Environment

- Ambient Temperature: -40° to 140°F
- Relative Humidity: 0 to 100%

Shipping Weight: 4 lbs.

Dimensions: W 7" X H 6.5" X D 4.5"

